

WANT  
TO KNOW  
MORE?

**zolyd.eu**

## CE STATEMENT OF COMPLIANCE WITH EUROPEAN UNION DIRECTIVES

Zolyd declares that this product is in compliance with the essential requirements and other relevant provisions from the following Directives: 2014/30/EU; 2011/65/EU, as applicable.  
The technical documentation required by the Conformity Evaluation Process is in Zolyd's possession and can be requested through [support@zolyd.eu](mailto:support@zolyd.eu).

## DISPOSAL OF BATTERIES AND ELECTRICAL OR ELECTRONIC EQUIPMENT WASTE

The existence of this symbol on the product, batteries or respective packaging, signifies that this product and the contained batteries can not be disposed as domestic waste. It is the user's responsibility to deliver this product at a batteries, electrical or electronic recycling pick-up point. The pick-up and separate recycling contributes for the preservation of natural resources and suppresses potential negative consequences for the human health and the environment resultant of inadequate disposal of dangerous substances contained in batteries and electrical or electronic equipment. For additional informations regarding batteries, electrical or electronic recycling pick-up points, please contact your local municipal services.

## TECHNICAL ASSISTANCE

Regarding technical issues, please visit [www.zolyd.eu](http://www.zolyd.eu) or contact us through [support@zolyd.eu](mailto:support@zolyd.eu).

## COMPATIBILITY

**Motherboard:** ATX, Micro-ATX, Mini-ITX  
**CPU cooler:** 165 mm max. height  
**GPU:** 355 mm max. length  
**Connections:** 2x USB-A 3.0; 1x USB-C 3.1; 1x audio in/out  
**Expansion slots:** 7  
**Liquid cooling (not included):** Front: 120 / 240 / 360 mm • Rear: 120 mm

## SAFETY - EU 2023/988

### Electrical installation:

- Use only with certified and compatible computer power supply units.
- Do not connect or disconnect fans while the equipment is powered on.

### Risk of electric shock:

- Never expose the PC case or fans to liquids.
- Do not use the product if cables or connectors are damaged.

### Ventilation and heating:

- Ensure proper airflow when installing the PC case.
- Do not block the ventilation openings.
- Avoid placing the product near heat sources or in excessively humid environments.

### Mechanical safety:

- Be careful when handling internal metal edges — risk of cuts.
- Keep fingers, hair, and objects away from operating fans.

### Use and maintenance:

- This product is intended for indoor use only.
- Clean dust regularly with a dry cloth; never use solvents or aggressive cleaning products.
- Do not attempt to modify or repair fans without qualified technical assistance.

### Intended users:

- Not suitable for children.
- Keep small parts (screws, accessories) out of the reach of children and pets.



ACCESSORIES



x16 MB screws



x7 storage unit screws



x6 PSU screws



x2 MB spacers



x8 2.5" storage unit pads



x8 2.5" storage unit screws



x5 cable ties

OPENING THE PC CASE

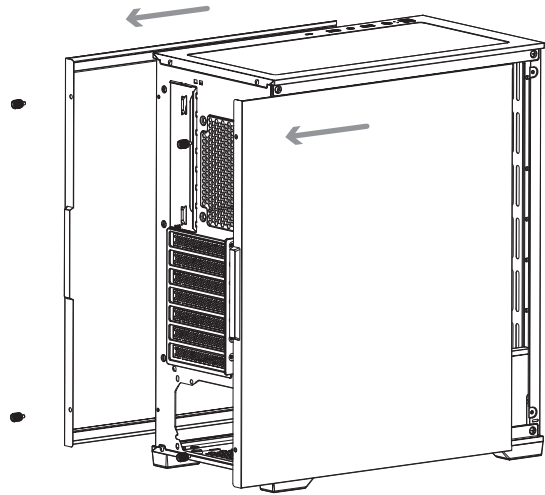

Remove the screws located at the back of the left panel. Slide the panel backwards to release it.

Remove the screws located at the back of the right panel. Slide the panel backwards to release it.

STORAGE UNITS INSTALLATION

2x 3.5" STORAGE UNITS

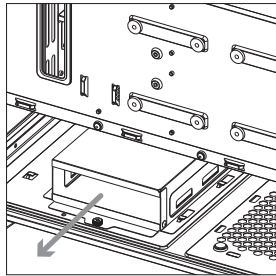

1.1) Remove the storage units drawer from the PC case. Remove the screw and pull it out.

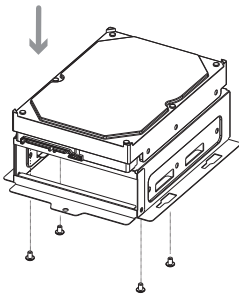

1.2) Install the first unit by placing it on top of the drawer and attaching the screws through the bottom.

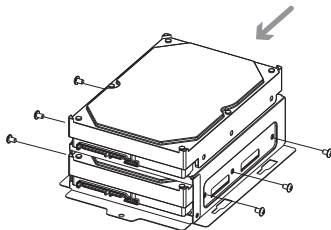

1.3) Install the second unit by inserting it on the drawer and attaching the screws through the side.

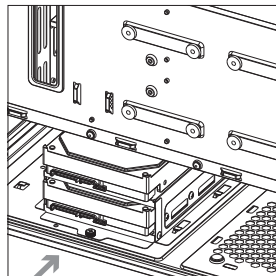

1.4) Reinstall the drawer back into the PC case.

STORAGE UNITS INSTALLATION

2x 2.5" STORAGE UNITS

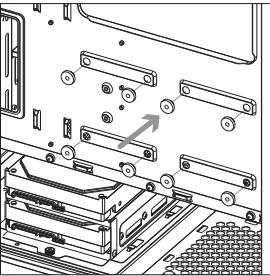

1.1) Install the 2.5" storage unit pads on the PC case.

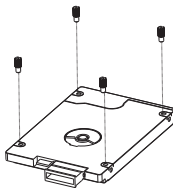

1.2) Attach the 2.5" storage unit screws on the storage unit.

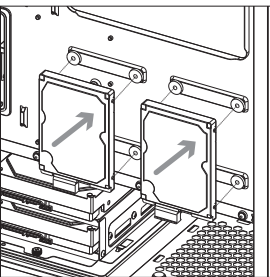

1.3) Install the storage units on the PC case by pushing the screws through the pads.

EXTRA FANS OR LIQUID COOLING INSTALLATION

Align the fans or radiators with the fixation holes on the top, front and rear panels or PSU chamber on the PC case. Attach the fixation screws on the fans or radiators.

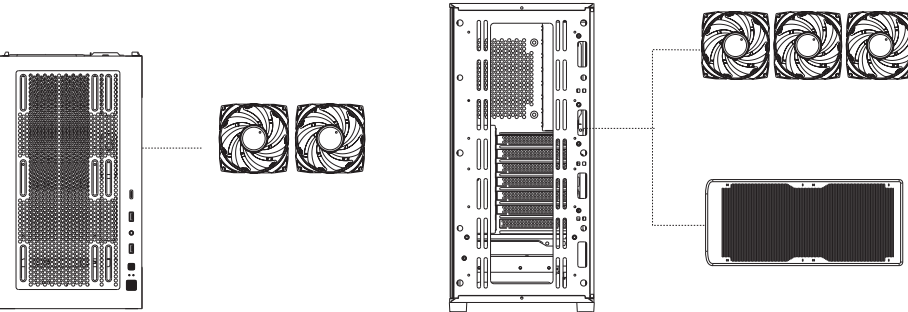

Top panel: 2x 120 mm or 2x 140 mm fans.

Front panel: 3x 120 mm or 2x 140 mm fans. 120, 240 or 360 mm radiators.

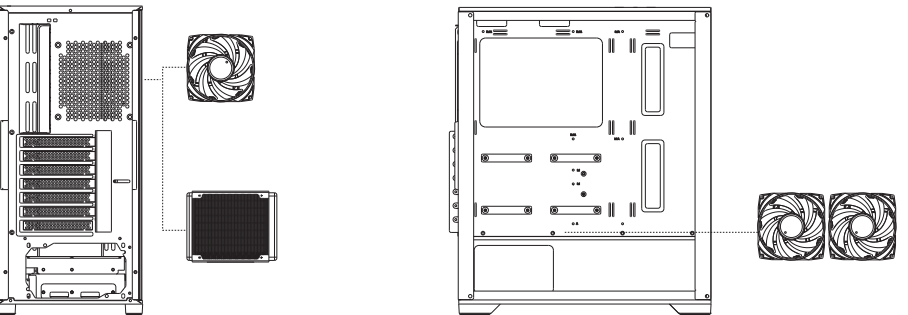

Rear panel: 1x 120 mm fan. 120 mm radiator.

PSU chamber: 2x 120 mm fans.