



WANT  
TO KNOW  
MORE?

**zolyd.eu**

| FOLD

6

Attach the radiator on the computer case with the provided screws.

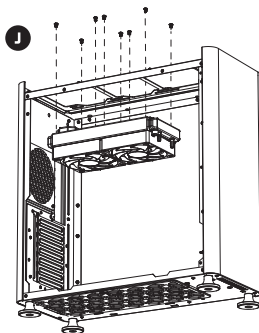

7

Connect the pump and fan plugs onto the motherboard:



4 pin PWM →  
CPU\_FAN header



3 pin ARGB →  
5V ARGB header



3 pin pump →  
AIO\_PUMP or  
PUMP header



Internal USB 2.0 →  
Internal USB 2.0  
header

8



In order to display the CPU temperature on the pump, download and install the software from the product page at [zolyd.eu](https://zolyd.eu) or scan this QR code.

| FOLD

| FOLD

## CE STATEMENT OF COMPLIANCE WITH EUROPEAN UNION DIRECTIVES

Zolyd declares that this product is in compliance with the essential requirements and other relevant provisions from the following Directives: 2014/30/EU; 2011/65/EU, as applicable.  
The technical documentation required by the Conformity Evaluation Process is in Zolyd's possession and can be requested through [support@zolyd.eu](mailto:support@zolyd.eu).

## DISPOSAL OF BATTERIES AND ELECTRICAL OR ELECTRONIC EQUIPMENT WASTE

The existence of this symbol on the product, batteries or respective packaging, signifies that this product and the contained batteries can not be disposed as domestic waste. It is the user's responsibility to deliver this product at a batteries, electrical or electronic recycling pick-up point. The pick-up and separate recycling contributes for the preservation of natural resources and suppresses potential negative consequences for the human health and the environment resultant of inadequate disposal of dangerous substances contained in batteries and electrical or electronic equipment. For additional informations regarding batteries, electrical or electronic recycling pick-up points, please contact your local municipal services.

## SAFETY - EU 2023/988

### Safety Information

Risk of electric shock: Always disconnect the computer from the power supply before installing, disassembling or performing maintenance on the cooling system.  
Burn hazard: After use, components may reach high temperatures. Allow them to cool down before any direct contact.  
Chemical hazard: This product contains sealed coolant. In case of leakage: Avoid direct contact with skin and eyes; Ventilate the area and immediately shut down the system; Contact authorized technical support.

### Safe Installation

Use only components supplied by the manufacturer. Improper installation may cause overheating or system failure.  
Avoid bending, twisting, or crushing the tubes. This may compromise liquid circulation.  
Secure the radiator and fans to ensure effective airflow.  
Do not install the product if it shows visible damage (leaks, cut cables, etc.).

### During Operation

Regularly monitor CPU temperature using appropriate software.  
Do not obstruct the radiator or fans.  
The system does not require coolant refilling. Never attempt to open the closed loop.  
During operation, the fan blades rotate at high speed. Avoid contact with moving blades to prevent injury.

| FOLD

| FOLD

**ZOLYD**

**hyper  
flow  
240**

ARGB 240 MM LIQUID  
COOLING SYSTEM

User Guide

| FOLD

## COMPONENTS

**A**

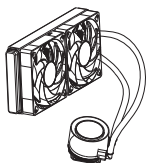

Liquid cooling system x 1

**B**

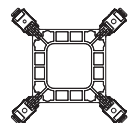

Intel backplate x 1

**C**

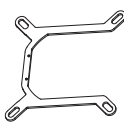

Intel / AMD bracket x 1

**D**

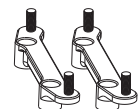

AMD bracket x 1

**E**



Thermal paste x 1

**F**



Intel / AMD screw nuts x 4

**G**



AMD bracket screws x 5

**H**



Intel screw studs x 4

**I**



Intel 2011 screws x 4

**J**



Computer case screws x 8

## INSTALLATION

**1**

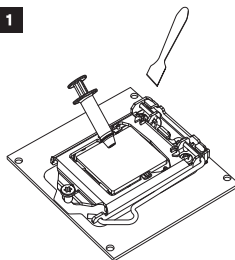

Clean the CPU surface if needed.  
Apply thermal paste to the CPU.

**2**

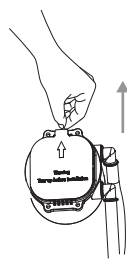

Remove the protective film from  
the pump base.



Select step 3, 4 or 5 according with the CPU socket.

**3**

**INTEL 775 / 115X + 1200 / 1366 / 1700 + 1851**

**3.1**

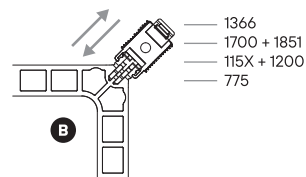

Adjust the backplate according to  
the CPU socket.

**3.2**

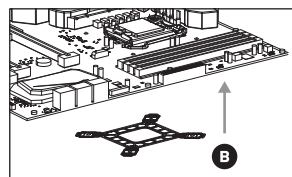

Place the backplate on the back of  
the motherboard.

**3.3**

Apply the Intel screw studs on the backplate  
through the motherboard's side.  
Apply the Intel / AMD bracket on the pump.  
Place the pump base onto the CPU surface.  
Secure it by attaching the screw nuts onto  
the screw studs.

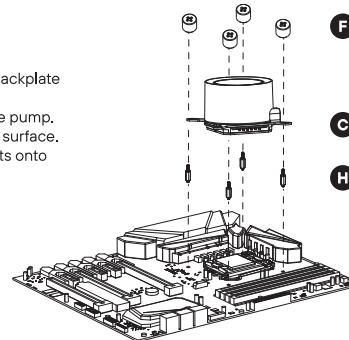

**4**

**INTEL 2011**

Apply the Intel / AMD bracket on the pump.  
Place the pump base onto the CPU surface.  
Secure it by attaching the Intel 2011 screws.

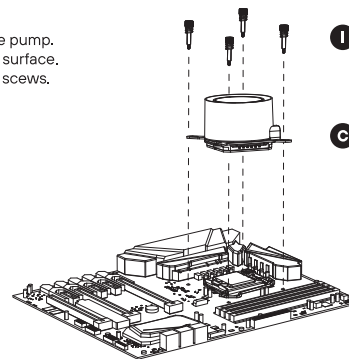

**5**

**AMD AM4 / AM5**

**5.1**

Remove the motherboard's original AMD  
bracket, but keep the backplate.

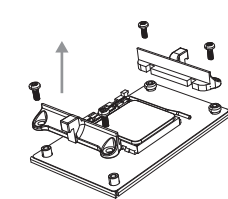

**5.2**

Apply the AMD bracket on the motherboard.  
Attach it to the original backplate.

Apply the Intel / AMD bracket on the pump.  
Place the pump base onto the CPU surface.  
Secure it by attaching the screw nuts onto  
the bracket studs.

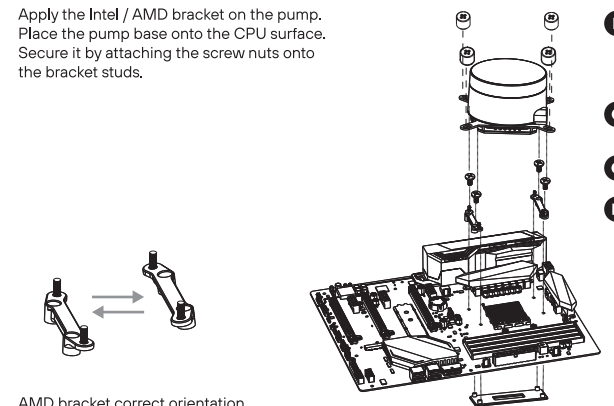

AMD bracket correct orientation.